

DIN 936

Hexagon nuts

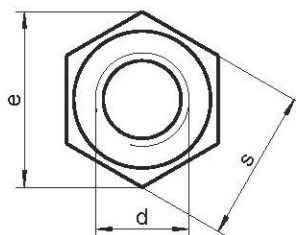
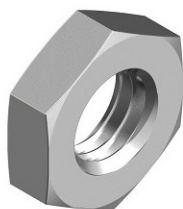

d	m min.	s	e	⌀
M5	3,5	8	8,79	8
M6	4	10	11,05	10
M7	4	11	12,12	11
M8	5	13	14,38	13
M10	6	17	18,90	17
M12	7	19	21,10	19
M14	8	22	24,49	22
M16	8	24	26,75	24
M18	9	27	29,56	27
M20	9	30	32,95	30
M22	10	32	35,03	32
M24	10	36	39,55	36
M27	12	41	45,20	41
M30	12	46	50,85	46

Grade	SU
▲●	1000
▲●	1000
▲●	1000
▲●	1000
▲●	1000
▲●	1000
▲●	1000
▲●	1000
▲●	1000
▲●	1000
▲●	1000
▲●	500
▲●	500
▲●	200

■ A1 / ▲ A2 / ● A4 | SU: Sales unit | All measurements in mm | Other dimensions on request.

Example item no. 934-2-10 DIN 934 - A2 - M10