

DIN 6330

Dado esagonale, tipo B, altezza = $1,5 \times \varnothing$

DIN 6330

Hexagon nuts, type B, height = $1,5 \times d$

Disponibile

Aisi 304 / A2 

Available

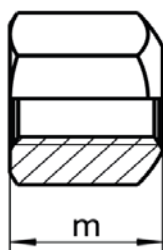
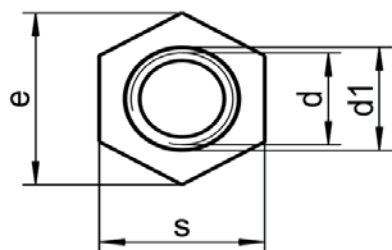

m	9	12	15	18	24	30	36	45	54	63
s	10	13	16	18	24	30	36	46	55	65
e	11,05	14,38	17,77	20,03	26,75	33,53	39,98	51,28	61,31	72,61
d1	7	9	11,5	14	18	22	26	32	38	44
	10	13	16	18	24	30	36	46	55	65
l/d	M6	M8	M10	M12	M16	M20	M24	M30	M36	M42