





**STAINLESS STEEL HINGES and LATCHES**  
**CERNIERE E CHIUSURE IN ACCIAIO INOSSIDABILE**

	 <p>do not drill the holes before receiving the product!!</p>				
	<p>-∅ Holes 4,5 mm                  -Countersinking 8 mm</p>				
Art.8052-B / M8052-B			Art.8052 / M8052		
Swivel hasp type B AISI 304			Also available Blister Line		
Item code / Alternative code	Box	Master	Item code / Alternative code	Box	Blister
80529004004 / M8052-2-B	12	120	0000098502 / B985	10 Blister	(1 blister = 1 pz)





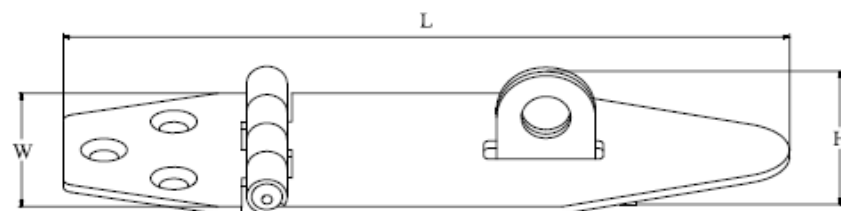
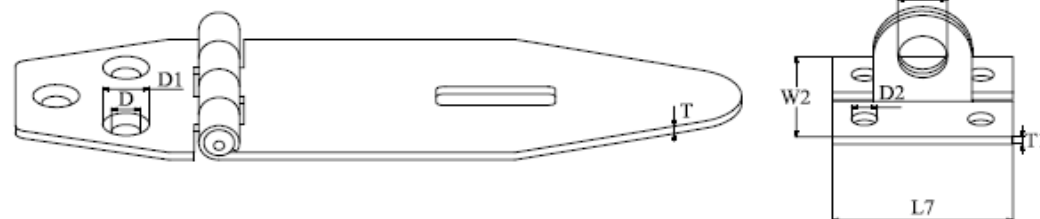

	+/-5%	+5%/-2%	+5%/-2%	+5%/-2%	+/-5%	+/-5%
<b>L</b>	<b>D</b>	<b>D1</b>	<b>D2</b>	<b>D3</b>	<b>L7</b>	
<b>mm</b>	<b>mm</b>	<b>mm</b>	<b>mm</b>	<b>mm</b>	<b>mm</b>	
125	4,5	8	4,5	8,5	31	



	+/-5%	+0/-0.13	+0/-0.13	+/-5%	+/-5%
<b>H</b>	<b>T</b>	<b>T1</b>	<b>W</b>	<b>W2</b>	
<b>mm</b>	<b>mm</b>	<b>mm</b>	<b>mm</b>	<b>mm</b>	
19	1,5	1,5	40	29	

**STAINLESS STEEL HINGES and LATCHES**  
**CERNIERE E CHIUSURE IN ACCIAIO INOSSIDABILE**

	 non praticare i fori prima di ricevere il prodotto!!				
	-Ø Fori 4,5 mm -Svasatura 8 mm				
Art.8052-B / M8052-B		Art.8052 / M8052-B		Disponibile anche Linea Blister	
Chiusura porta lucchetto tipo B AISI 304		Codice articolo / Codice alternativo		Box	Blister
80529004004 / M8052-2-B		12	120	00000098502 / B985	10 Blister (1 blister = 1 pz)

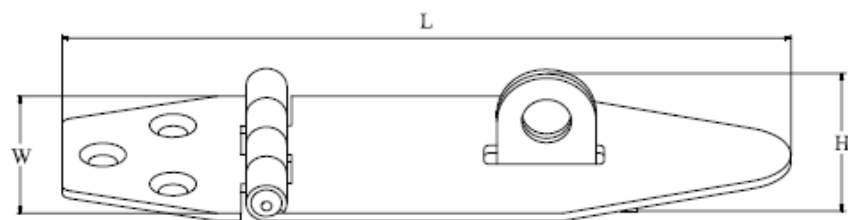

+/-5% +5%/-2% +5%/-2% +5%/-2% +/-5% +/-5%

L mm	D mm	D1 mm	D2 mm	D3 mm	L7 mm
125	4,5	8	4,5	8,5	31

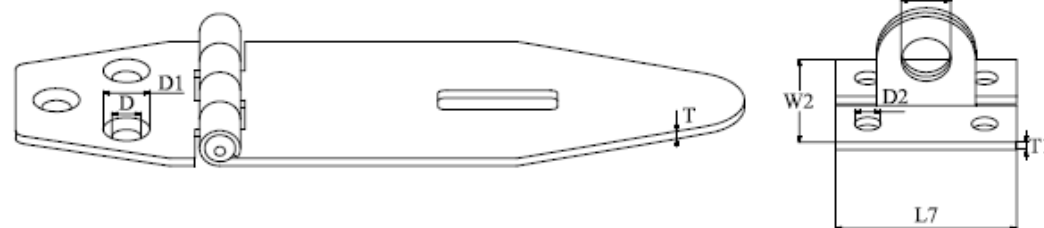

+/-5% +0/-0.13 +0/-0.13 +/-5% +/-5%

H mm	T mm	T1 mm	W mm	W2 mm
19	1,5	1,5	40	29